

One-touch fittings—threaded type

Ordering code

GBB 01 01

① ② ③

① Model

GBB: Male connector
(G thread)



GBD: Male & female
connector(G thread)[Note1]



GBU: Double female
connector(G thread)



GBZ: Hexagon head cap
plug(G thread)[Note2]



01: G1/8
02: G1/4
03: G3/8
04: G1/2

② Thread connection I

③ Thread connection II

01: G1/8
02: G1/4
03: G3/8
04: G1/2

[Note1] For GBD series, Thread I is Female thread, Thread II is male thread; [Note2] For GBZ series, no thread II and thread I is male thread.

Specification

Operating pressure range	0~10kgf/cm ² (0~1.0MPa)
Negative pressure	-750mmHg(10Torr)
Proof pressure	3.0MPa
Ambient and fluid temperature (°C)	0~150

Product feature

1. Variable models can be widely used in every kind of pneumatic systems.
2. High circulation performance bear the same flow with the volume of the tube innerdiameter.
3. The nickel plated body is anti-corrosion and anti-pollution, which allows a broader application.
4. Metal fittings can be used in high temperature environment.

Configuration table of tubing thread

Product series	Thread connection I	Thread connection II			
		01	02	03	04
GBB	01	●	●	●	
	02		●	●	●
	03			●	●
	04				●
GBD	01		●	●	●
	02			●	●
	03				●
	04				
GBU	01	●			
	02		●		
	03			●	
	04				●
Product series	Thread connection				
	01	02	03	04	
GBZ	●	●	●	●	

Dimensions

GBB Series

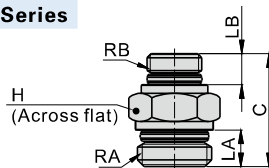

Model\Item	RA	RB	LA	LB	C	H	Weight(g)	PCS/bag
GBB0101	G1/8	G1/8	5.5	5.5	15.5	10	3.2	10
GBB0102	G1/4	G1/8	6.5	5.5	20	14	7.3	10
GBB0103	G3/8	G1/8	7	5.5	21.5	19	15.3	10
GBB0202	G1/4	G1/4	6.5	6.5	21	14	8.4	10
GBB0203	G3/8	G1/4	7	6.5	22.5	19	15.9	10
GBB0204	G1/2	G1/4	8.5	6.5	24.5	22	22.4	10
GBB0303	G3/8	G3/8	7	7	23.5	19	17.8	10
GBB0304	G1/2	G3/8	8.5	7	25	22	23	10
GBB0404	G1/2	G1/2	8.5	8.5	27	22	23.3	10

GBD Series

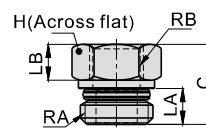

Model\Item	RA	RB	LA	LB	C	H	Weight(g)	PCS/bag
GBD0102	G1/4	G1/8	6.5	8	14.5	14	8.8	10
GBD0103	G3/8	G1/8	7	8	14	19	17.7	10
GBD0104	G1/2	G1/8	8.5	8	16	22	29.5	10
GBD0203	G3/8	G1/4	7	8.5	16	19	16.4	10
GBD0204	G1/2	G1/4	8.5	8.5	16	22	26.3	10
GBD0304	G1/2	G3/8	8.5	9.5	19	22	24.5	10

GBU Series

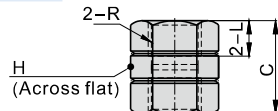

Model\Item	R	L	C	H	Weight(g)	PCS/bag
GBU0101	G1/8	6.5	17	14	8.4	10
GBU0202	G1/4	8.5	23	17	25.4	10
GBU0303	G3/8	9.5	25	21	40	10
GBU0404	G1/2	11	28	25	46.6	10

GBZ Series

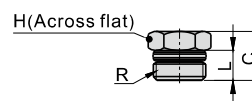

Model\Item	R	L	C	H	Weight(g)	PCS/bag
GBZ01	G1/8	5.5	9	10	3.7	10
GBZ02	G1/4	6.5	12.5	14	9.2	10
GBZ03	G3/8	7	14	19	18	10
GBZ04	G1/2	8.5	16	22	29.4	10